



# SOUTH CENTRAL EXTENSION/ DOWNTOWN HUB



## PROJECTS

TITLE

LIGHT RAIL EXTENSION

TYPE

CONSTRUCTION FACT SHEET / Q1 2020  
valleymetro.org/southcentral

## Let's Get to Work

The South Central Extension/Downtown Hub will connect with the current light rail system in downtown Phoenix and operate south to Baseline Road. The project also includes a light rail transit hub in downtown Phoenix, new stations and public art.

Construction activities began in October 2019 starting in the downtown area. In early 2020, utility relocation will begin along Central Avenue. The complete construction timeline is being developed and will be communicated as the project progresses, including the details about where and when construction work will occur.

Each phase of construction has specific characteristics regarding when and where the work occurs. The projected is expected to open for operations in 2024.

## Construction Elements



Utility Relocation and Street Work



Track Installation



Stations, Art and Landscaping



Overhead Power Systems and Testing

Property access maintained	●	●	●	●
Traffic maintained (one lane each direction)	●	●	●	●
Left and U-turns at designated intersections	●	●	●	●
Nighttime work	●	●		
24-hour work	●	●		
Main work area: in the roadway	●	●	●	
Main work area: next to the roadway	●		●	
Main work area: trackway			●	●

## WHAT TO EXPECT

- Access maintained to businesses and residences
- Notification and coordination of construction activities
- Modification to traffic lanes and sidewalks
- Temporary bus stop relocations
- Daytime and nighttime work
- Notification and coordination of temporary utility interruptions

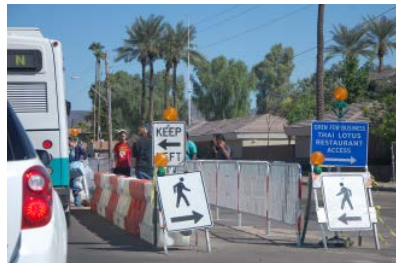

## SAFETY TIPS



Be alert around construction



Allow for extra travel time



Follow traffic signals and message boards



Use designated crosswalks



Limit distractions

To subscribe to weekly email updates, contact your Community Outreach Coordinator. For more information, please visit [valleymetro.org/southcentral](http://valleymetro.org/southcentral).



### Julie Cruz Gilfillan

Downtown - Lincoln  
Community Outreach Coordinator  
jcruz@valleymetro.org  
O: 602.495.8274

### Victoria Bray

Downtown - I-17 Bridge  
Business Assistance Coordinator  
vbray@valleymetro.org  
O: 602.495.8284

### Julie Smith

Lincoln - Broadway  
Community Outreach Coordinator  
jmsmith@valleymetro.org  
O: 602.744.5563

### Flor D. Mason

I-17 Bridge - Baseline  
Business Assistance Coordinator  
fmason@valleymetro.org  
O: 602.523.6032

### Khandle Hedrick

Broadway - Baseline  
Community Outreach Coordinator  
khedrick@valleymetro.org  
O: 602.523.6039





# SOUTH CENTRAL EXTENSION/ DOWNTOWN HUB



PROJECTS

TITLE

LIGHT RAIL EXTENSION

TYPE

CONSTRUCTION FACT SHEET / Q1 2020  
valleymetro.org/southcentral

## ROUTE MAP

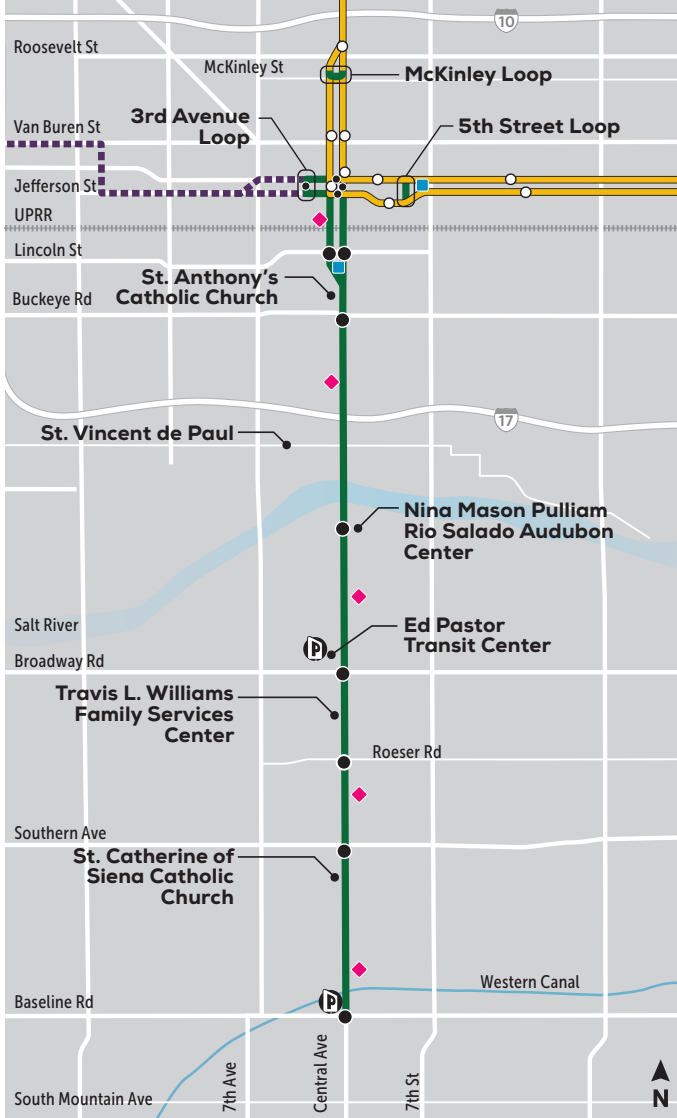

## Downtown Phoenix

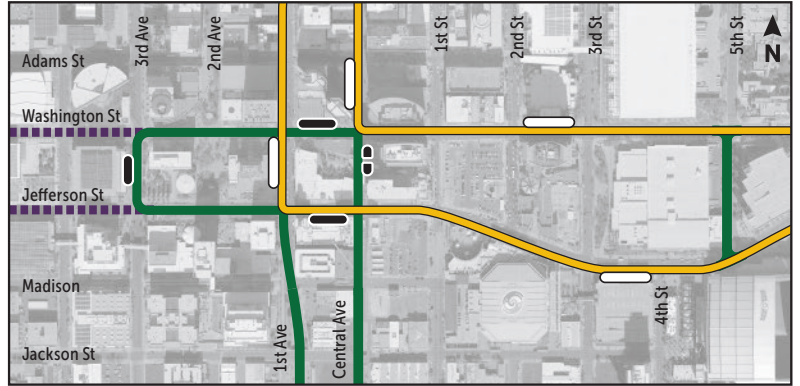

### LEGEND

- Valley Metro Rail/Station Platform
- South Central Extension/  
Downtown Hub/Station Platform
- Capitol/I-10 West Extension
- Park-and-Ride
- Traction Power Substation (TPSS)
- Signal Building

## MINIMIZING IMPACTS

Valley Metro is committed to minimizing construction impacts and maintaining a safe environment. During construction, Community Outreach and Business Assistance Coordinators are assigned full-time to serve as a direct contact to neighboring residents and businesses provide information, address concerns and solve problems. Information will be shared through personal contact, public meetings, door hangers, mailers, emails, social media and the ConstructVM app.

Business signage will be provided to help direct customers to driveways and entrances. Business owners can also take advantage of other business assistance programs offered by Valley Metro, the city of Phoenix and community business partners.

## SOUTH CENTRAL EXTENSION/DOWNTOWN HUB COMMUNITY OFFICE

5040 S. Central Avenue | Phoenix, AZ 85040 | 602.687.8585

Monday, Tuesday, Wednesday: 9 a.m. - 5 p.m.

Thursday: Noon - 7 p.m.

First and Third Saturday: 9 a.m. - Noon

*or by appointment*



/valleymetro



/valleymetroconstruction



/extensionsurcentral



Download the Construct VM app  
for real-time construction information.